

DOORS OPEN  
SCALE 0.08 : 1

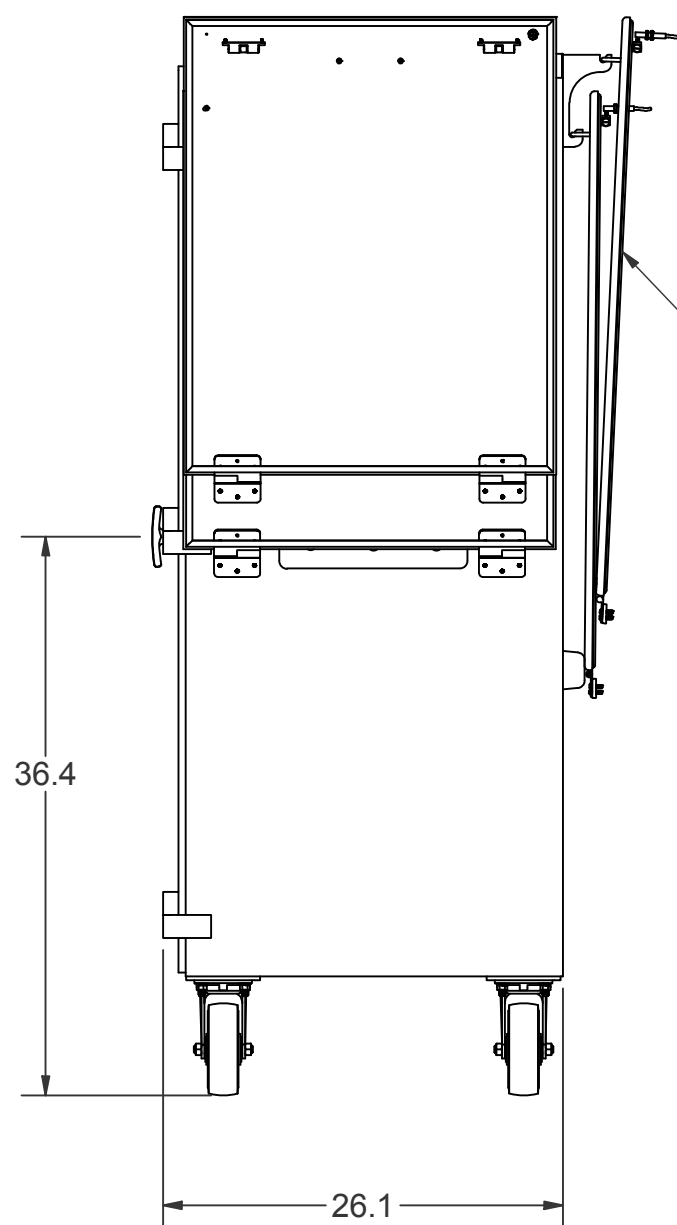

NOVA1 Upper Doors.

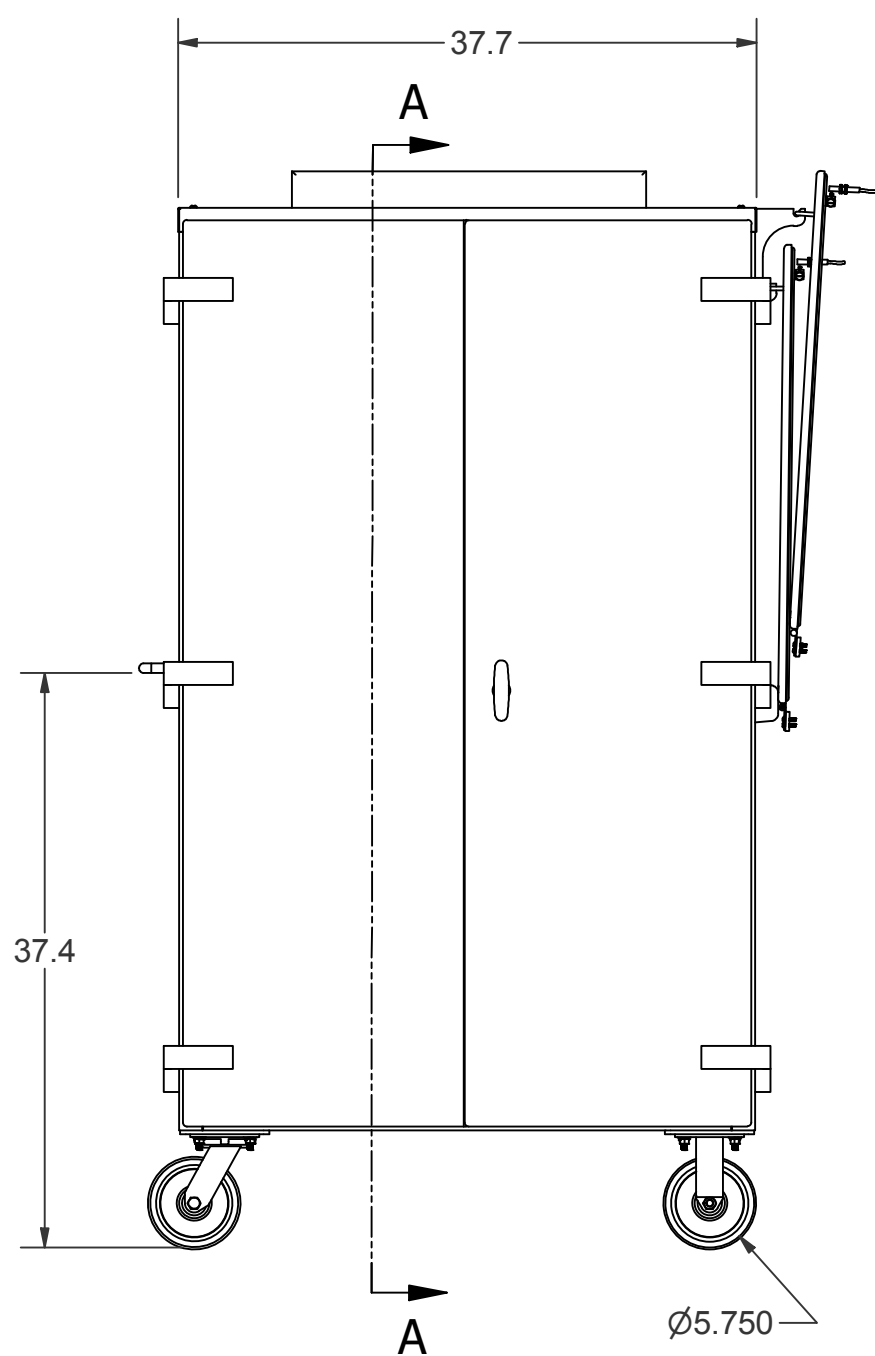
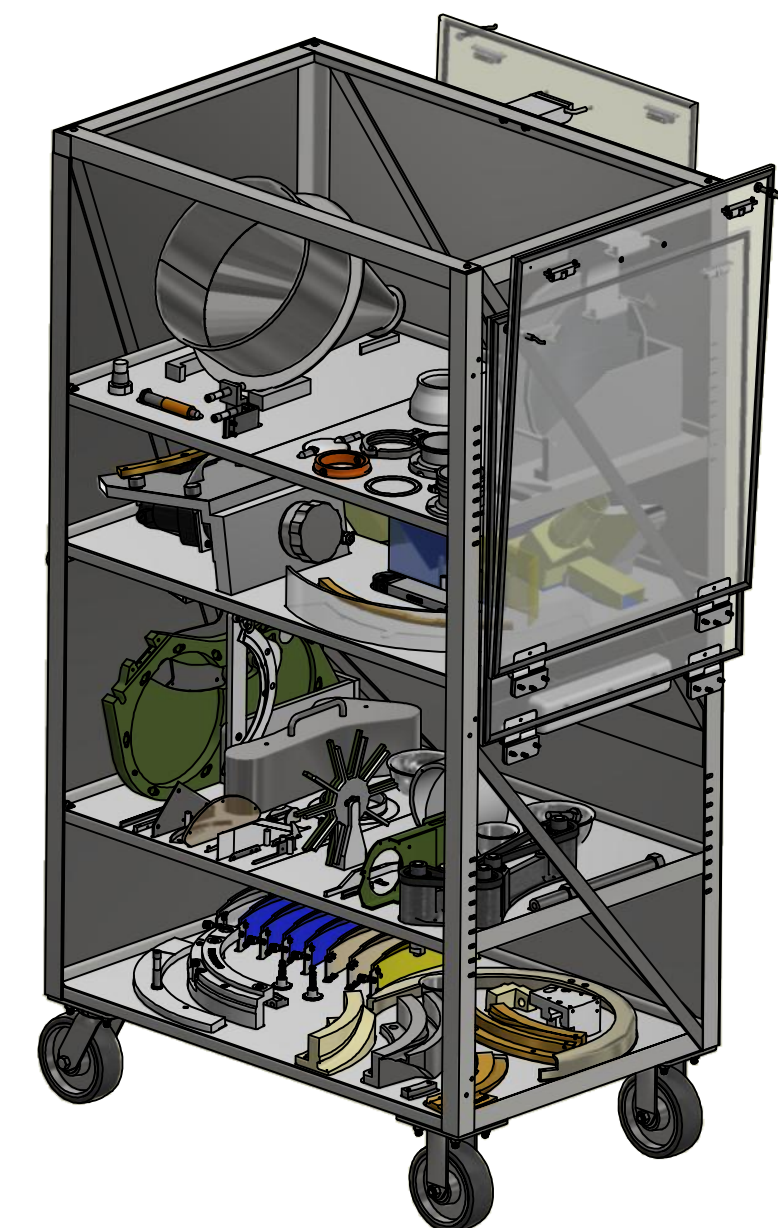

ROOF, DOORS AND RH PANEL REMOVED  
SCALE 0.08 : 1

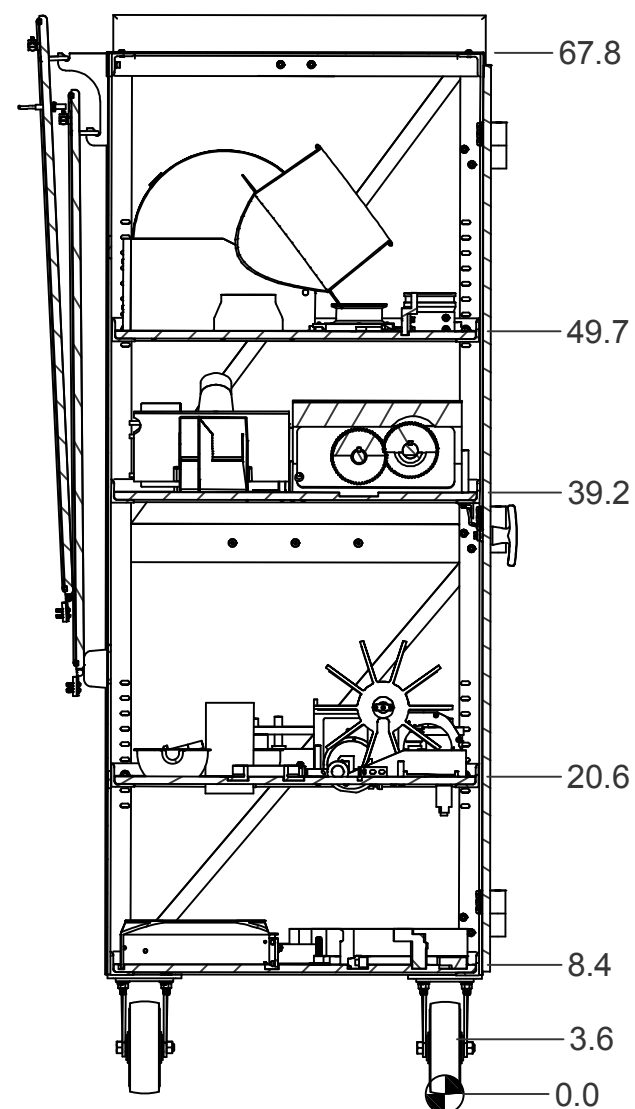

SECTION A-A  
SHELF HEIGHT  
SCALE 0.08 : 1

IPR, Inc. Confidential

PREPARED	mtate	1/18/2019
CHECKED		
ENGINEER		
APPROVAL		

Note: This document is to be treated as confidential and is not to be reproduced in any form whatsoever. Parts and or apparatus in accordance with or similar to this document not to be manufactured for others except on the written approval of IPR Inc.  
UNLESS OTHERWISE SPECIFIED ALL DIMENSIONS ARE IN INCHES AND INCLUDE FINISHES.  
TOLERANCES: Fractions +/- 1/64, Angles +/- 1; 4 Place Decimals +/- .0005, 3 Place Decimals +/- .005, 2 Places +/- .01, 1 Place +/- .025

**IPR, Inc.** 1241 Hardt Circle  
Bartlett, IL 60103

TITLE:  
**NOVA PARTS CART ASSEMBLY**

PRODUCT: PARTS CART	PART NO. NOVA-00-001	REV. 0
SCALE: .08 : 1	DRAWING NO. NOVA-00-001	DATE 4/5/19
		SHEET 1 of 3



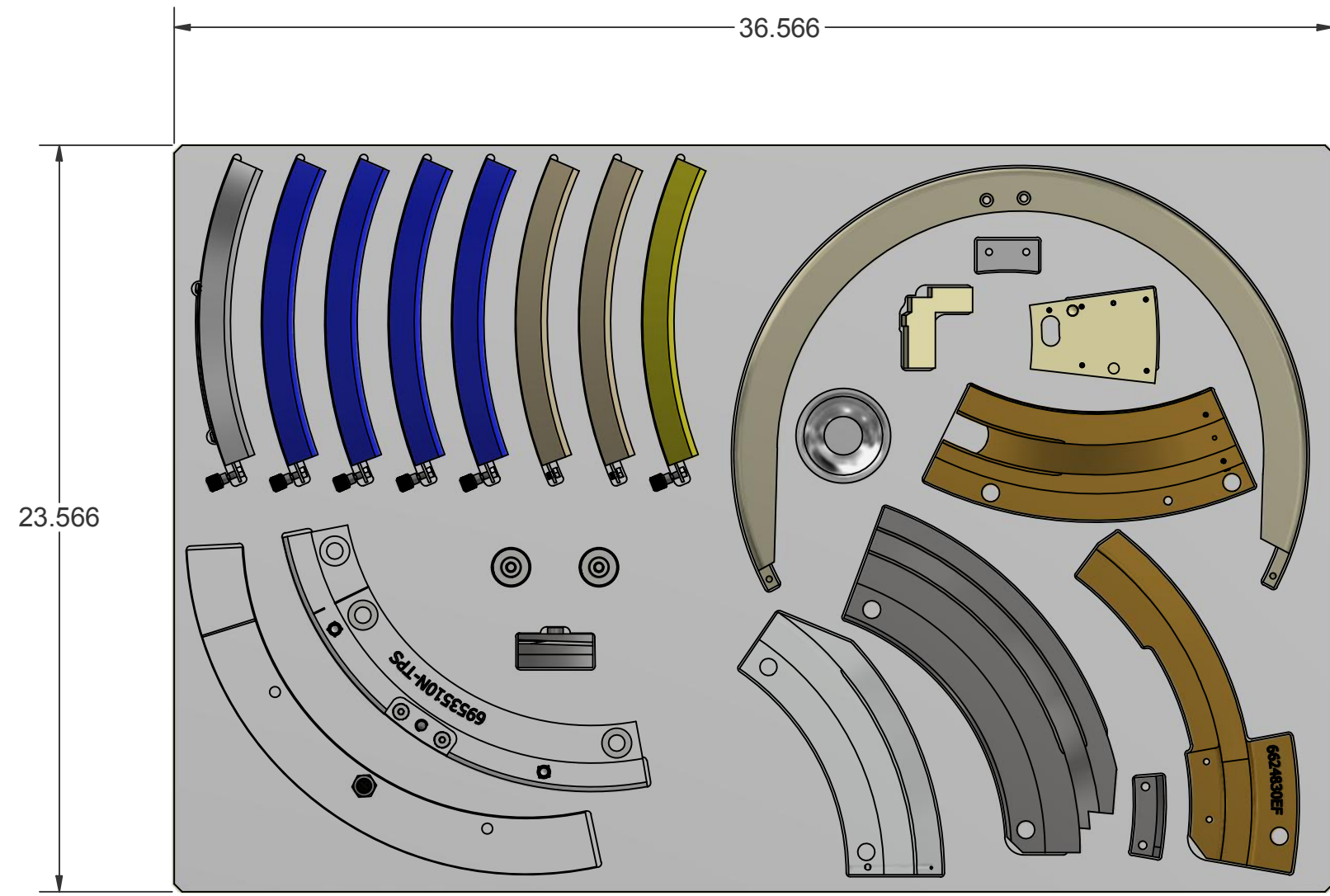

NOVA-00-100  
SHELF, CAM COMPONENTS ASSY  
SCALE .2

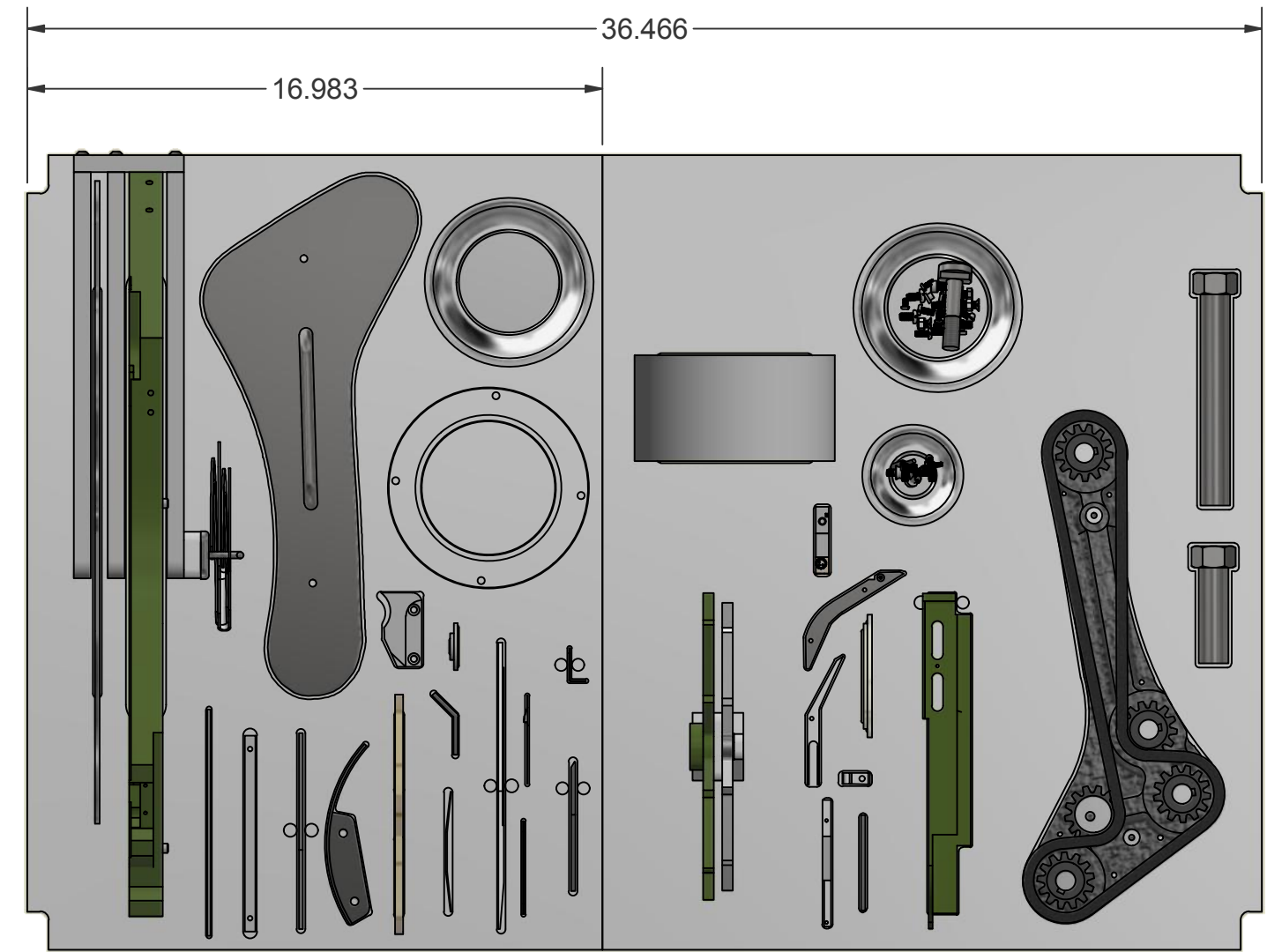

NOVA-00-102  
ADJUSTABLE SHELF, FEEDER COMPONENTS ASSY  
SCALE .2

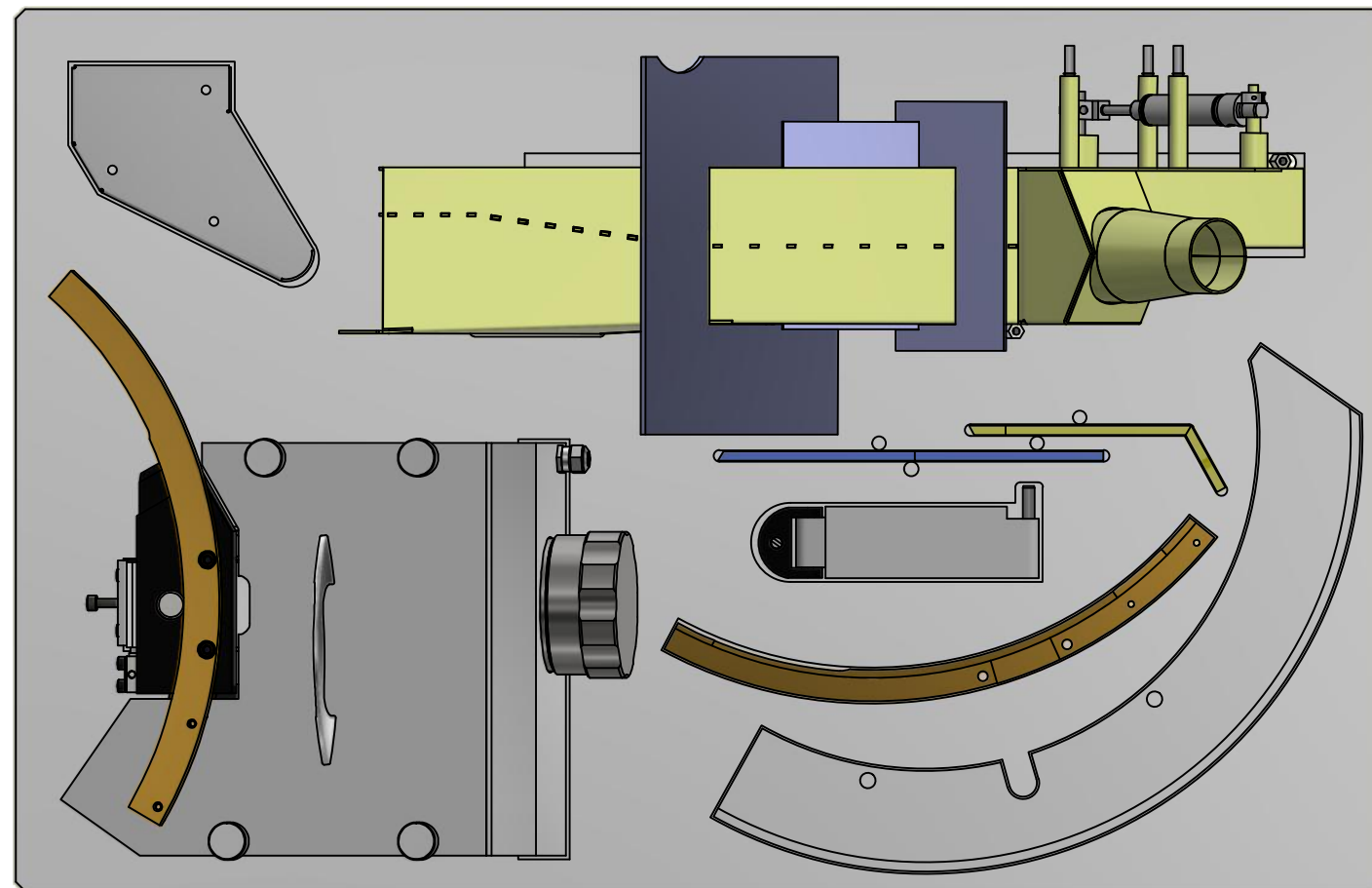

NOVA-00-101  
SHELF, WEIGHT & CHUTE ASSY  
SCALE .2

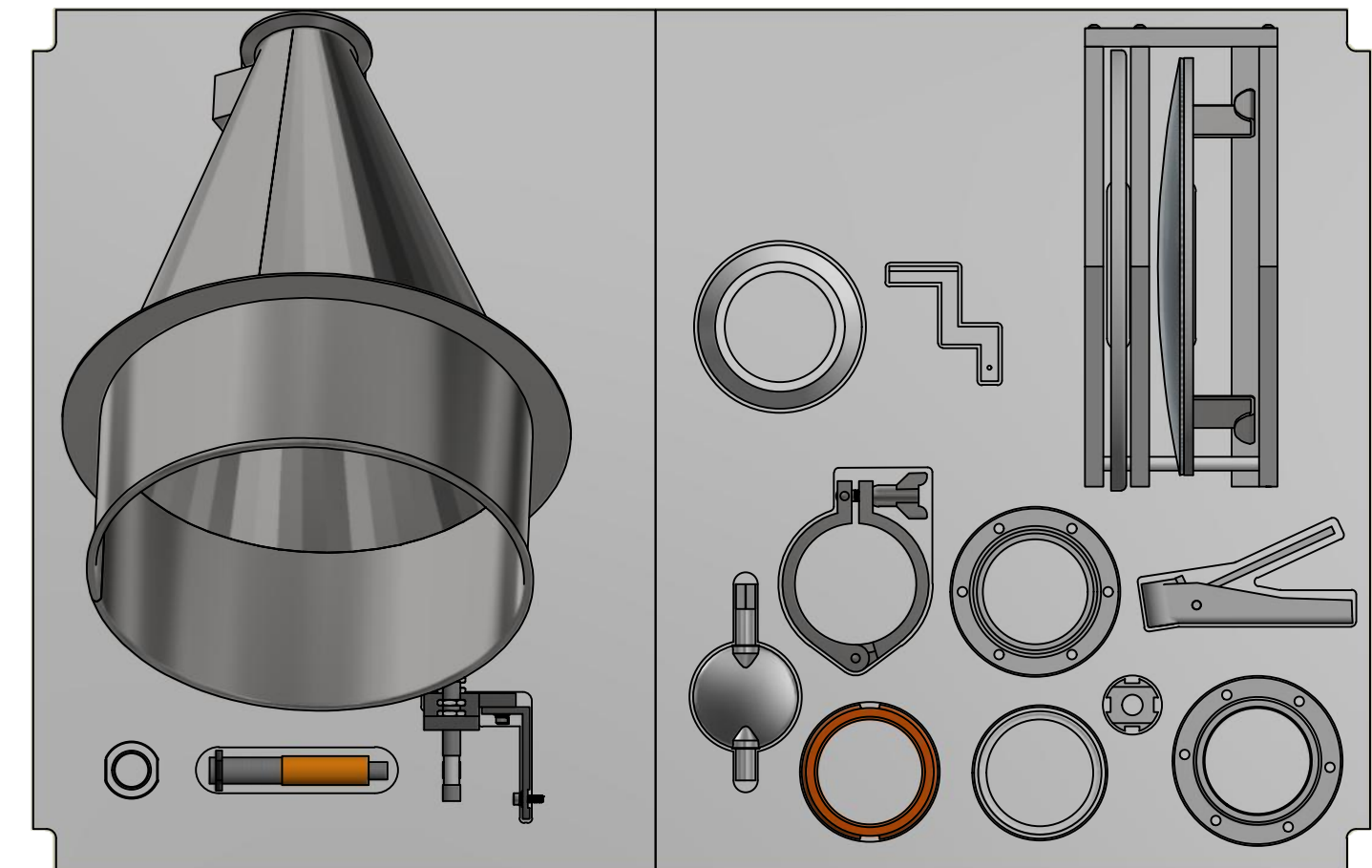

NOVA-00-103  
ADJUSTABLE SHELF, HOPPER COMPONENTS ASSY  
SCALE .2

IPR, Inc. Confidential

PREPARED	mtate	1/18/2019	<p><b>IPR, Inc.</b> 1241 Hardt Circle Bartlett, IL 60103</p>	
CHECKED				
ENGINEER				
APPROVAL				
<p>Note: This document is to be treated as confidential and is not to be reproduced in any form whatsoever. Parts and or apparatus in accordance with or similar to this document not to be manufactured for others except on the written approval of IPR Inc.</p>			TITLE:	
<p>UNLESS OTHERWISE SPECIFIED ALL DIMENSIONS ARE IN INCHES AND INCLUDE FINISHES. TOLERANCES: Fractions +/- 1/64, Angles +/- 1; 4 Place Decimals +/- .0005, 3 Place Decimals +/- .005, 2 Places +/- .01, 1 Place +/- .025</p>			<p><b>NOVA PARTS CART ASSEMBLY</b></p>	
PRODUCT:	NOVA-00-001	PART NO.	NOVA-00-001	REV. 0
SCALE:	.08 : 1	DRAWING NO.	NOVA-00-001	DATE 4/5/19
				SHEET 2 of 3



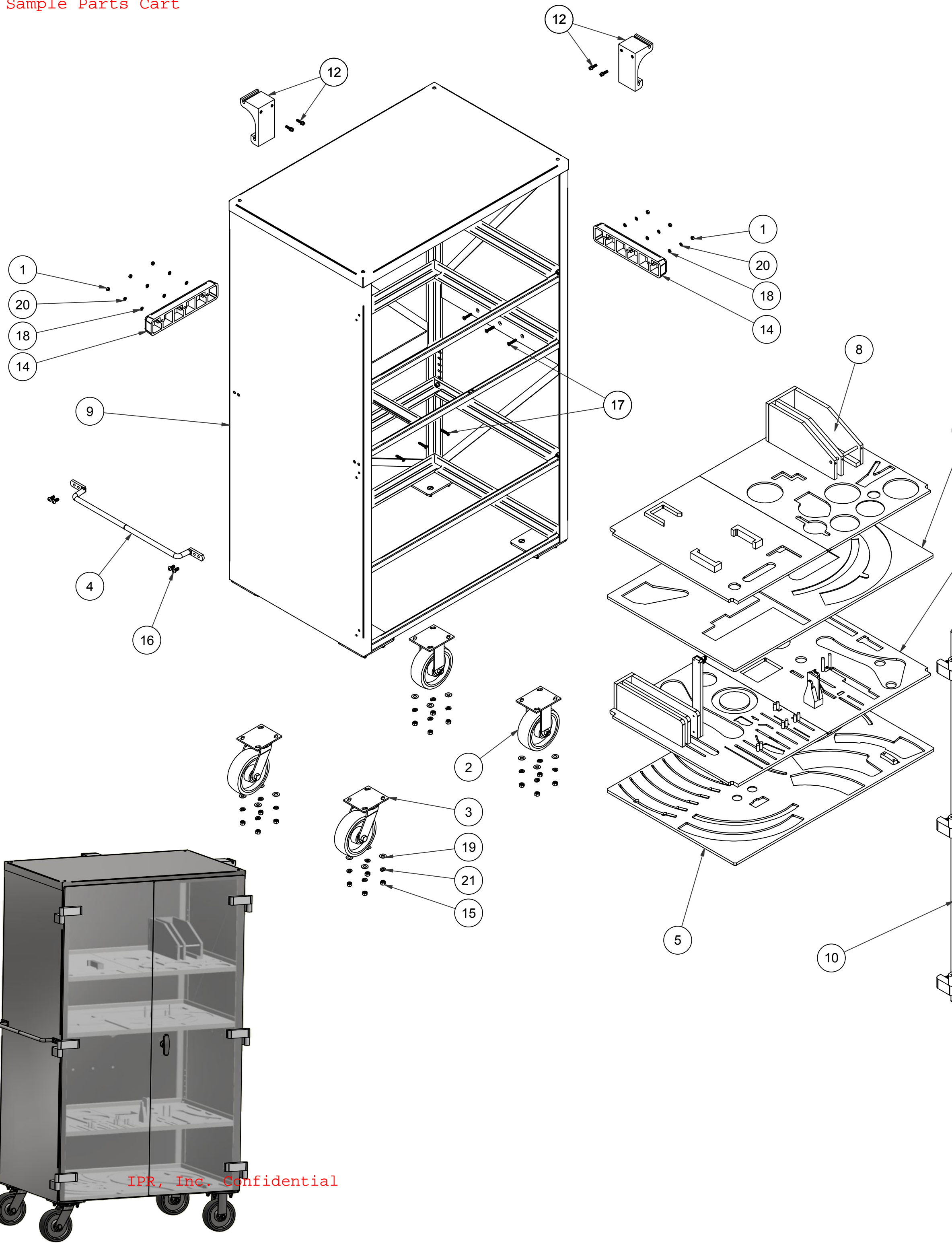

ITEM	PART NUMBER	QTY	DESCRIPTION	REV
1	4701508	6	NUT, M6 HEX SS	0
2	CASTA906R	2	CASTER, RIDGID, BRG, SS, 6"OD	0
3	CASTA906S	2	CASTER, SWIVEL, SS, 6" OD	0
4	HDL10035	1	FORMED 304 SS PULL HANDLE, 24"	0
5	NOVA-00-100	1	SHELF, CAM COMPONENTS ASSY	0
6	NOVA-00-101	1	SHELF, WEIGHT & CHUTE ASSY	0
7	NOVA-00-102	1	ADJUSTABLE SHELF, FEEDER COMPONENTS ASSY	0
8	NOVA-00-103	1	ADJUSTABLE SHELF, HOPPER COMPONENTS ASSY	0
9	NOVA-00-106	1	CABINET FRAME WELDMENT	0
10	NOVA-00-107-LH	1	DOOR ASSEMBLY, LEFT	0
11	NOVA-00-107-RH	1	DOOR ASSEMBLY, RIGHT	0
12	NOVA-00-120	2	DOOR HANGER ASSY	0
13	NOVA-00-127	2	PULL HANDLE NUT	0
14	NOVA-00-134	2	BUMPER, WHITE	0
15	NUTA13710	16	NUT, 3/8-16 HEX SST	0
16	SCRM30820	4	SCREW, M8 X M20 BTN HD SST	0
17	SCRM70613	6	SCREW M6 X 35 FLT HD SOC, SS	0
18	WASHER11610	6	WASHER, FLAT M6 SST	0
19	WASHER13710	16	WASHER, FLAT 3/8 SST	0
20	WASHER21610	6	WASHER, LOCK M6 SST	0
21	WASHER23710	16	WASHER, LOCK 3/8 SST	0

PREPARED	mtate	1/18/2019
CHECKED		
ENGINEER		
APPROVAL		

<b>IPR, Inc.</b>		1241 Hardt Circle Bartlett, IL 60103	
TITLE: <b>NOVA PARTS CART ASSEMBLY</b>			
PRODUCT: PARTS CART	PART NO. NOVA-00-001	REV.	0
SCALE: .08 : 1	DRAWING NO. NOVA-00-001	DATE	4/5/19
		SHEET	3 of 3

Note: This document is to be treated as confidential and is not to be reproduced in any form whatsoever. Parts and or apparatus in accordance with or similar to this document not to be manufactured for others except on the written approval of IPR Inc.

UNLESS OTHERWISE SPECIFIED ALL DIMENSIONS ARE IN INCHES AND INCLUDE FINISHES.  
TOLERANCES: Fractions +/- 1/64, Angles +/- 1; 4 Place Decimals +/- .0005, 3 Place Decimals +/- .005, 2 Places +/- .01, 1 Place +/- .025